

# How To: Install A Transfer Cut Decal



1  
Clean surface



2  
Use masking tape to temporarily adhere to intended surface and as a "hinge".

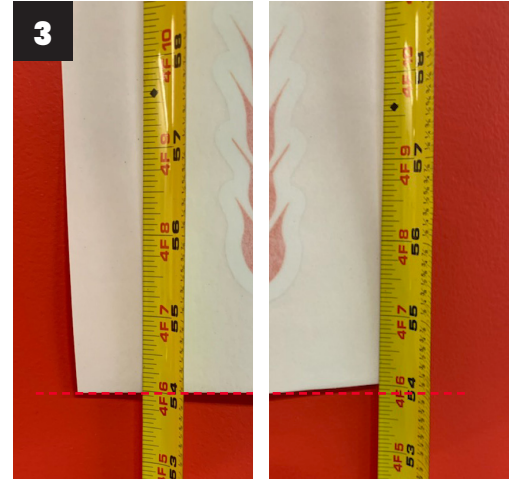

3  
Use bottom of decal as a place to measure from - so it's level.

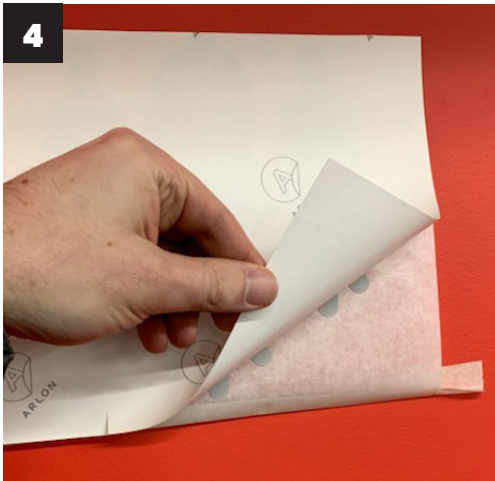

4  
Peel off decal backing.

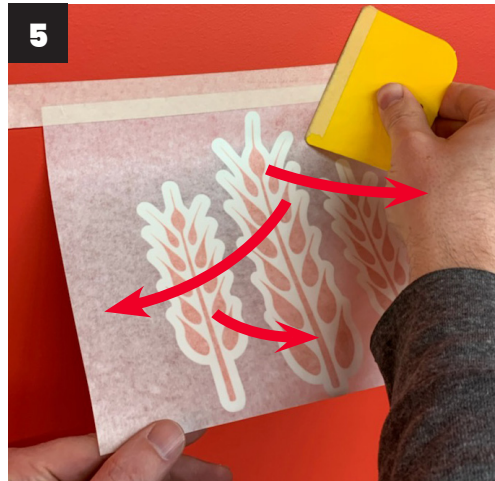

5  
Using a decal application squeegee, press and apply decal to intended surface in pattern shown above. \*



6  
NOTE: Press hard when applying.



7  
Peel / remove application mask. Go slowly. Be careful as the decal may peel away from surface.



8  
Stand back and admire your job well done!

\* If you do not have a decal application squeegee, you can use a credit card, your wallet, or a pack of post-it notes.